

## Precautions

- Use and keep product away from reach of children and pets.
- Do not ingest the Thermal Grease, and avoid its contact with skin and eyes. If contact is made with skin, wash off with water. If ingested or irritation persists, seek medical attention.
- To prevent possible injuries, gloves must be worn while handling this product.
- Excessive force exerted on the fan may cause damage to the fan and/or system.
- Avoid inserting objects into the fan while it is in operation.
- Check the components list and condition of the product before installation. If any problem is found, contact the retailer to obtain a replacement.
- Zalman is not responsible for any damages caused by overclocking.
- During transportation of the system, the cooler must be removed. Zalman is not responsible for any damages that occur during the transport of a system.
- Product design and specifications may be revised to improve quality and performance.

**Disclaimer)** Zalman Tech Co., Ltd. is not responsible for any damages due to external causes, including but not limited to, improper use, problems with electrical power, accident, neglect, alteration, repair, improper installation, or improper testing.

## Specifications

Category		Description
Cooler	Heatsink Material	Pure Al, Pure Cu
	Weight	920g
	Dimensions	135(L) X 100(W) X 160(H)mm
	Bearing Type	2 Ball-bearing
	Rotation Speed	1000~2150rpm $\pm$ 10%
	Noise Level	20dBA ~ 39dBA
	Input Voltage	12V
PWM Mate	PWM Duty Cycle	25 ~ 100% $\pm$ 5%
	Connector Type	4-Pin

# Components

## Common Components



Cooler(CNPS10X)  
& PWM Mate



Thermal Grease



Double-sided Tape



Extension Cable



Washers

## Intel Socket 1156/775 Components



Socket 1156/775 Clip



Socket 1156/775  
Clip Support



Socket 775  
Backplate



Socket 1156/775  
Bolt Guides



Socket 1156 Nuts



Socket 1156/775  
Bolts (Silver)

## Intel Socket1366 Components



Socket 1366 Clip



Socket 1366 Clip Support



Socket 1366 Bolts(Gold)

## AMD Components Socket AM3/AM2+/AM2/754/939/940



AMD Clip

# Socket Components

## ► Space Requirements

The cooler's installation requires unobstructed space with dimensions of 140mm(width),140mm(length), 165mm(height), and the CPU as a central reference point. Please check if components such as ODDs and PSU protrude into the required space.

## ► Air Guide Removal

Air guides on enclosures must be removed, before the cooler's installation, for they protrude into the cooler's required space.

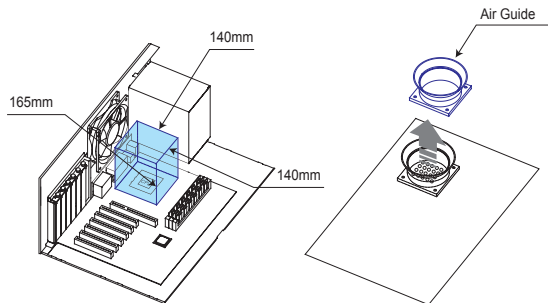

# Installation

## ■ Intel Socket Installation

### A. Socket 1156/775 Installation

Insert the Bolt Guides and Bolts into the Clip Support according to the socket-type using the diagram below as reference.

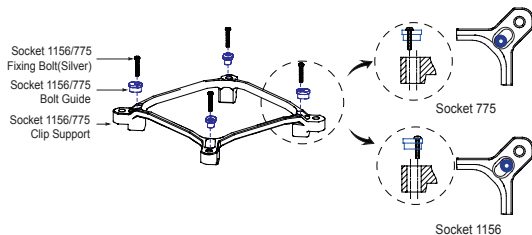

#### ⚠ Warning

Please make sure the Bolt Guides are correctly according to the socket-type.

# Installation

## A-1. Socket 775 Installation

Install the Socket 1156/775 Clip Support with the Socket 775 Backplate.

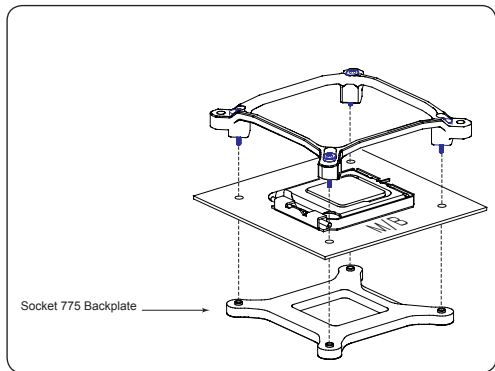

## A-2. Socket 1156 Installation

Install the Socket 1156/775 Clip Support with the Socket 1156 Nuts & Washers.

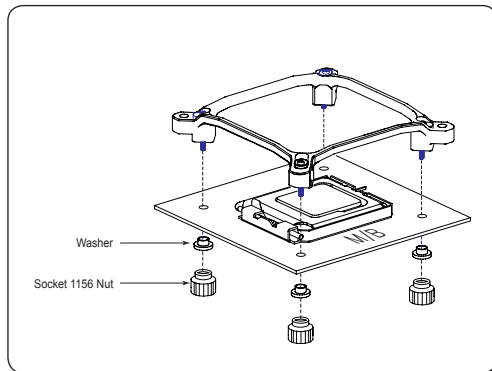

## B. Socket 1366 Installation

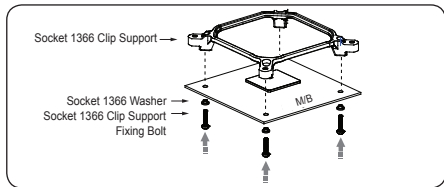

2. Clear off any particles or residue from the CPU's surface then spread (outwards from center) a thin but thorough layer of Thermal Grease on the CPU and the base of the cooler.

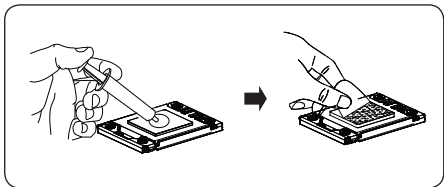

3. Insert the Intel Socket 1156/775 or Socket 1366 Clip through the cooler's heatpipes at an odd angle then center its orientation. Making sure that the cooler and the clip are centered, fasten the clip by tightening the Intel Socket Clip Fixing Bolts.

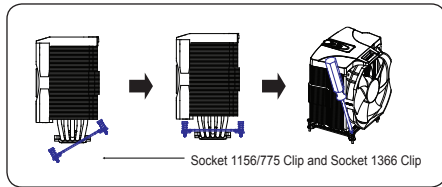

4. Connect the cooler's 4-pin connector to the motherboard's CPU Fan header.

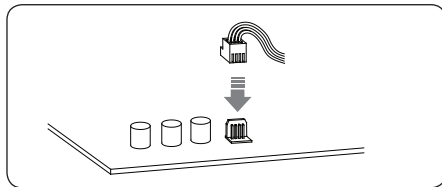

### ⚠ Warning

The PWM fan's operation will vary depending on the motherboard's BIOS settings. After installation, the PWM Control Mode must be activated in the BIOS. For details regarding PWM Control Mode, please refer to the motherboard's manual.

# Installation

## ■ AMD Socket Installation(Socket AM3/AM2+/AM2/754/939/940)



1. Clear off any particles or residue from the CPU's surface then spread (outwards from center) a thin but thorough layer of Thermal Grease on the CPU and the base of the cooler.

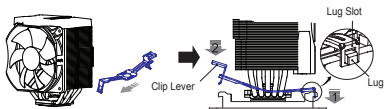

2. Place the cooler on the center of the CPU. Align and connect the Clip's Lug Slot with the Lug of the motherboard's retention frame. Press onto the Clip Lever when aligning the Lever's Lug Slot with the Lug.

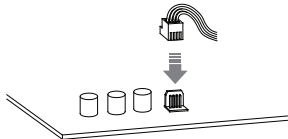

3. Connect the cooler's 4-pin connector to the motherboard's CPU Fan header.

### ⚠ Warning

The PWM fan's operation will vary depending on the motherboard's BIOS settings. After installation, the PWM Control Mode must be activated in the BIOS. For details regarding PWM Control Mode, please refer to the motherboard's manual.

# Installation

## ■ PWM Mate Operation

### [Mode Setting]

Each iterative press of the PWM Mate's button will select the next PWM Mate mode (4 modes).

Mode	Color Indicator	RPM	Manual RPM Dial
AUTO	HI	Red	N
	MED	Purple	
	LO	Blue	
MANUAL	Green	1000~2150RPM	Y

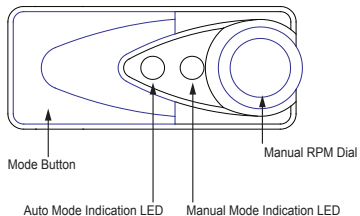

## ■ PWM Mate Extension Cable Operation

After removing the PWM Mate from the main unit, the PWM Mate can be relocated externally by connecting using the extension cable.

